



### Property Information

Owner	HUDSON JOHNNIE
Address	80 STELMACK DR
Mailing Address	80 STELMACK DR DERBY CT 06418
Land Use	
Land Class	R R

Neighborhood	106
Zoning	R-3
Acreage	2.14
Utilities	ALL PUBLIC ALL PUBLIC
Lot Description	LEVEL
Census Tract	1201



### Sketch

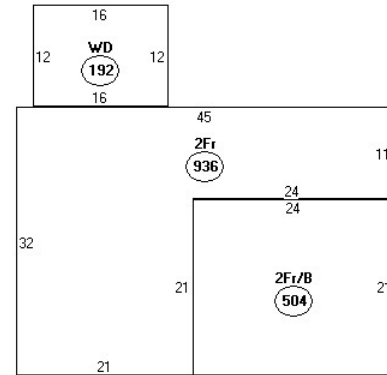

Descriptor/Area  
A: 2Fr/B  
504 sqft  
B: 2Fr  
936 sqft  
C: WD  
192 sqft

### Construction Details

Year Built	2020
Stories	2
Building Style	COLONIAL
Building Condition	BASIC
Total Rooms	9
Bedrooms	5
Bathrooms	2/1
Roof Style	
Primary Ext. Wall	ALUM/VINYL
Heating Type	WARM AIR
Heating System	WARM AIR
Heating Fuel	GAS
First Floor Area	
Total Living Area	2880

### Parcel Valuations

(Assessed value = 70% of Appraised Value)

	Appraised	Assessed
Buildings	361800	
Land	81700	
<b>Total</b>	<b>443500</b>	<b>310450</b>

### Sales History:

Sale Date	20211115
Sale Price	500000
Book/ Page	866 321