

Wheeling, WV

**Wash-Rite
Unlimited
Express
Car Wash**



Existing Locations



Parkersburg, WV

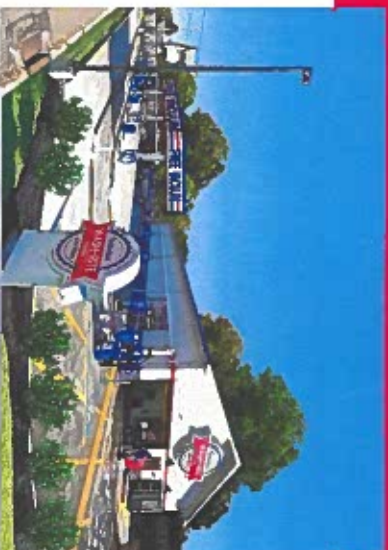

Vienna, WV



Parkersburg, WV 2



Bridgeport, WV



Moundsville, WV



Weirton, WV

Existing Locations



Steubenville, OH



Marietta, OH



Logan, OH



Wintersville, OH



Athens, OH



Calcutta, OH

State-of-the-Art Equipment

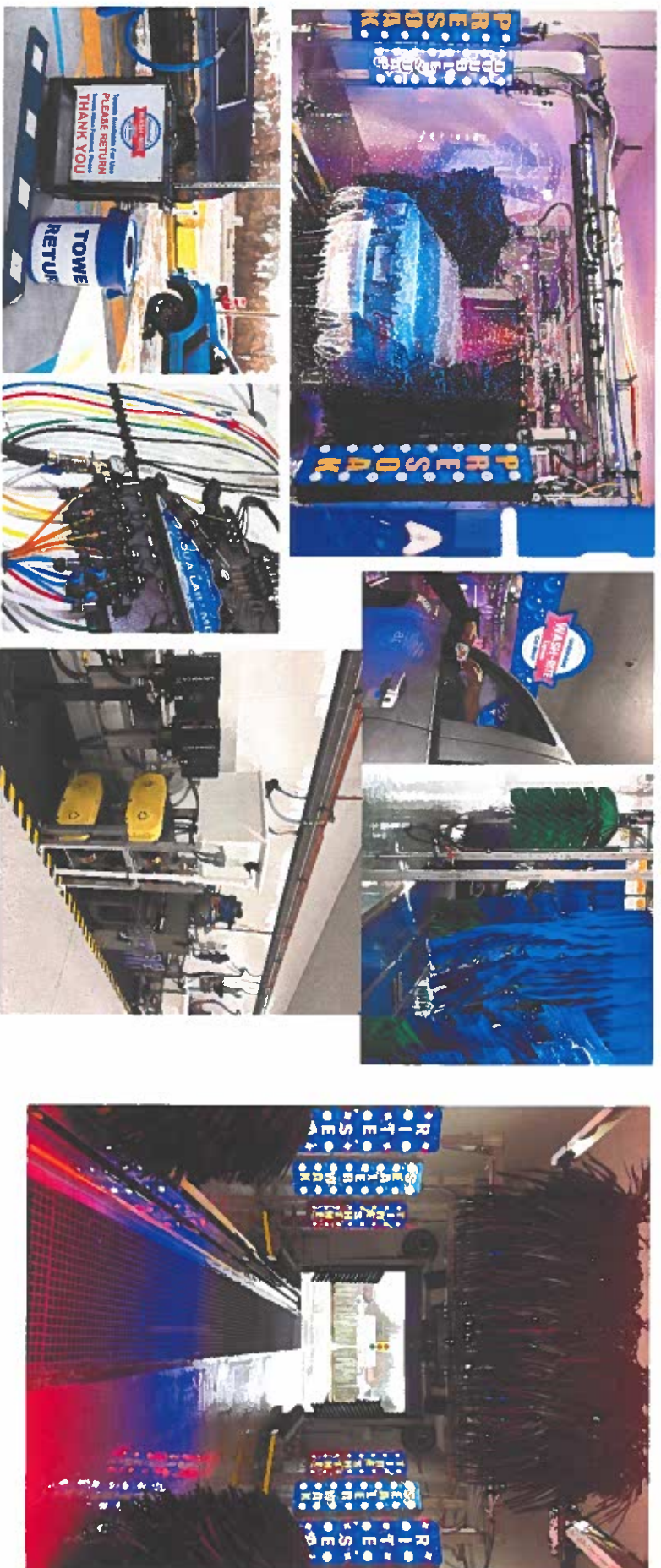

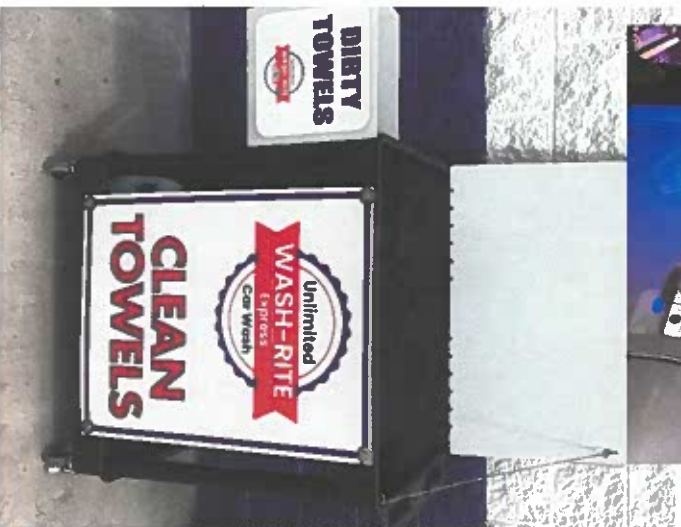

**Free Vacuum, Towels
and Air Freshener
with Every Wash**

Our Customers Love Us!

 **Misty Murphy** recommends **Wash-Rite Unlimited Express Car Wash – Marietta, OH**. Mar 1 · 🌐

Employees were friendly. It is a very nice place and you will leave a happy customer.

1 comment

 **Misty Bennett** recommends **Wash-Rite Unlimited – Bridgeport, WV**. Jan 21 · 🌐

Super nice and attentive staff. Great deal for unlimited washes. Awesome addition to Harrison county!

 **Traci Bonsell** recommends **Wash-Rite Unlimited – Bridgeport, WV**. Jan 2 · 🌐

Great deal! Unlimited washes, free vacuum, a place to wash your mats, complimentary window cleaner and air freshener. Super friendly staff and clean facility. Purchased the \$20 package and was NOT disappointed. ⭐⭐⭐⭐⭐

1

 **Cora Mckinnley Anderson** recommends **Wash-Rite Unlimited Express Car Wash – Marietta, OH**. Feb 28 · 🌐

I love how nice and friendly everyone is, especially to pets. They always make sure to include them and give them a treat!

Great place!

- Advertising across all social media platforms

Traffic Study – Wheeling, WV



J.B. Turman Engineering, PLLC

www.jbturman.com
304.733.1335
jbent@jbturman.com

May 28, 2015

Dear Ms. Deibert:

Reference: Wash-Rite Car Wash
Mount De Chantal Rd.
Wheeling, WV 26003
Ohio County

J.B. Turman Engineering, PLLC (JBE) has performed a trip generation evaluation for the project referenced above. Proposed trip generation estimates have been calculated for the Wash-Rite Car Wash development project in Wheeling, WV. The purpose of this correspondence is to summarize our findings of the trip generation evaluation.

Project Description

The Project consists of a proposed one-story, car wash facility that will have a single automatic wash tunnel, 20 vacuum bays and include office space for employees. The proposed facility will have the capacity to queue approximately 22 vehicles in line for the automatic wash tunnel. The proposed land use is summarized in Table 1 below.

Trip Generation Methodology

Our estimates of trip generation are based on the trip generation rates found in the Institute of Transportation Engineers (ITE) Trip Generation Manual, 11th Edition. The trips generated by the proposed land use were estimated based on the following land use codes (LUCs):

- LUC 948 Car Wash: An automated car wash is a facility that allows for the mechanical cleaning of the exterior of vehicles. Manual cleaning service may also be available at the facility. Trip generation estimates for this land use are based on the number of car wash bays available or the gross floor area of the facility.

Trip generation was estimated based on 100% vehicle mode share utilizing the ITE TripGen Web-based App. Calculations for the estimations are attached to this letter.

Project-Generated Trips

Table 1 summarizes the estimated Project-generated trips for the Project using LUC 948. Trip generation was estimated using LUC 948 since there are no manual car wash bays and it is a fully automatic facility. Due to the nature of the provided service, trip generation is expected to be influenced by weather and seasonality. It is anticipated that these results reflect temperate conditions.

May 28, 2015
Page 2

Table 1

Time Period	Estimated Trip Generation		Total
	In	Out	
Weekday AM Peak Hour	39	39	78
Weekday PM Peak Hour	19	22	41

¹ Estimated trip generation calculated using the ITE Trip Generation Manual, Seventh Edition 2011.
If you have any questions or need additional information, please feel free to contact our office at 304-733-1335 or via e-mail jbent@jbturman.com.

Respectfully Submitted,
J.B. Turman Engineering, PLLC

Brian Morton, P.E.
Project Manager

Attachments:
ITE Trip Generation Calculations

Traffic Study – Wheeling, WV

Automated Car Wash (948)

Vehicle Trip Ends vs. Car Wash Tunnels
 On a Weekday,
 Peak Hour of Adjacent Street Traffic:
 One Hour Between 4 and 5 p.m.

Settings/Location: General Urban/Suburban
 Number of Slides: 3
 Avg Num of Car Wash Tunnels: 1
 Directional Distribution: 50% entering, 50% exiting

Vehicle Trip Generation per Car Wash Tunnel		Standard Deviation
Average Rate	Range of Rates	33.09
77.50	50.00 - 104.50	

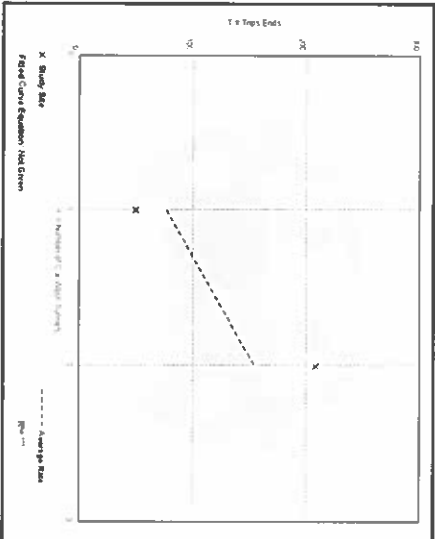

Automated Car Wash (948)

Vehicle Trip Ends vs. Car Wash Tunnels
 On a Saturday, Peak Hour of Generator

Settings/Location: General Urban/Suburban
 Number of Slides: 1
 Avg Num of Car Wash Tunnels: 1
 Directional Distribution: 45% entering, 54% exiting

Vehicle Trip Generation per Car Wash Tunnel		Standard Deviation
Average Rate	Range of Rates	...
41.00	41.00 - 41.00	

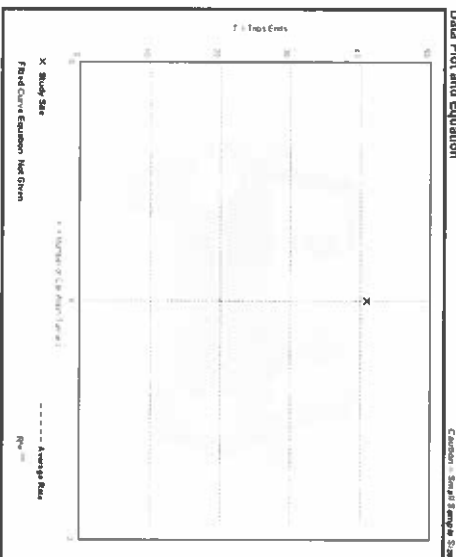

Water Consumption – Wheeling, WV

- Our express wash system uses approximately **30 gallons of water per car**.
- Daily water consumption varies depending on the number of vehicles washed:
- **Slow Day:** Approximately **100 cars**, resulting in about **3,000 gallons of water used**.
- **Average Day:** Approximately **300 cars**, resulting in about **9,000 gallons of water used**.
- **High-Volume Day:** Approximately **500 cars**, resulting in about **15,000 gallons of water used**.

On certain rainy days, if the conditions align just right, it is possible that we may use **no water at all** for the wash.



Rendering – Wheeling, WV



Site Plan – Wheeling, WV

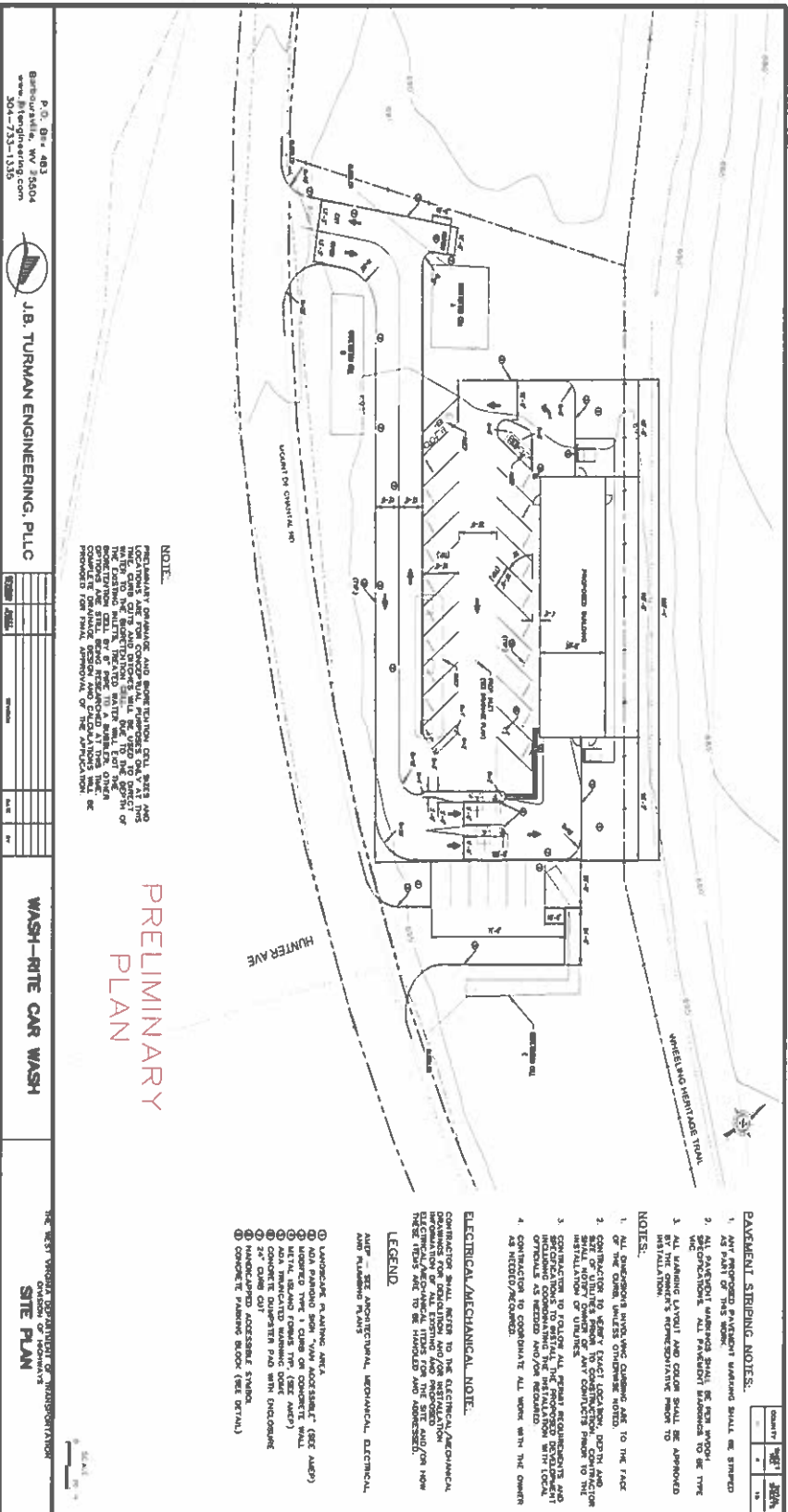

PARKING SIGNING NOTES.

1. ALL PARKING SIGNING SHALL BE STAMPED BY A LICENSED SURVEYOR.
2. ALL PARKING SIGNING SHALL BE FOR 9000 WHEELING TRAIL. ALL PARKING SIGNING TO BE TYPE "A" SIGNING.
3. ALL SIGNING LAYOUT AND COLOR SHALL BE APPROVED BY THE OWNER'S REPRESENTATIVE PRIOR TO INSTALLATION.

NOTES.

1. ALL DESIGNER'S ANNOTATIONS, CHANGES, AND TO THE FACE OF THIS PLAN SHALL BE MADE BY THE DESIGNER.
2. CONTRACTOR TO VERIFY EXISTING UTILITIES, DEPTH AND SIZE OF UTILITIES PRIOR TO CONSTRUCTION. CONTRACTOR TO VERIFY EXISTING UTILITIES PRIOR TO THE INSTALLATION OF UTILITIES.
3. CONTRACTOR TO FOLLOW ALL PERMITS, REQUIREMENTS AND REGULATIONS TO INSTALL, MAINTAIN, OPERATE AND REMOVE ALL UTILITIES FROM DRIVE/ROADS AS REQUIRED AND/OR REQUIRED.
4. CONTRACTOR TO COORDINATE ALL WORK WITH THE OWNER AS REQUIRED/ASAP.

ELECTRICAL/MECHANICAL NOTE.

CONTRACTOR SHALL REFER TO THE ELECTRICAL/MECHANICAL SPECIFICATIONS OF ALL EXISTING AND PROPOSED BUILDINGS. THESE ITEMS ARE TO BE HANDLED AND ADDRESSED.

LEGEND.

- ASHP – SEE ARCHITECTURAL, MECHANICAL, ELECTRICAL, AND PLUMBING PLANS
- ① LANDSCAPE PLANTING AREA
 - ② ADA PARKING SIGN "VAN ACCESSIBLE" (SEE ASEP)
 - ③ IMPROVED TRIP CURB ON CONCRETE SHALL BE 1/2" HIGH
 - ④ ADA INDICATED WALKING SURFACE
 - ⑤ CONCRETE CURB/STAIR PAD WITH CONCOURSE
 - ⑥ HANDICAPPED ACCESSIBLE STAIRS
 - ⑦ CONCRETE PARKING BLOCK (SEE DETAIL)

PRELIMINARY PLAN

NOTE:
PRELIMINARY DRAINAGE AND EROSION CONTROL SIZES AND LOCATIONS AND LOCATIONS WILL BE USED TO CHECK THE PROPOSED DRAINAGE SYSTEM. THE DEPTH OF DRAINAGE SHALL BE AS SHOWN. THE DEPTH OF DRAINAGE SHALL BE AS SHOWN. OTHER COMPLETE DRAINAGE DESIGN AND CALCULATIONS SHALL BE PROVIDED FOR THE APPROVAL OF THE JURISDICTION.

P. O. Box 483
Bassettville, WV 26004
www.jbturmanengineering.com
304-753-1300



J.B. TURMAN ENGINEERING, PLLC

NO.	DATE	BY	REVISION

WASH-RITE CAR WASH

SITE PLAN

THE WEST VIRGINIA DEPARTMENT OF TRANSPORTATION